

2

1

B

B

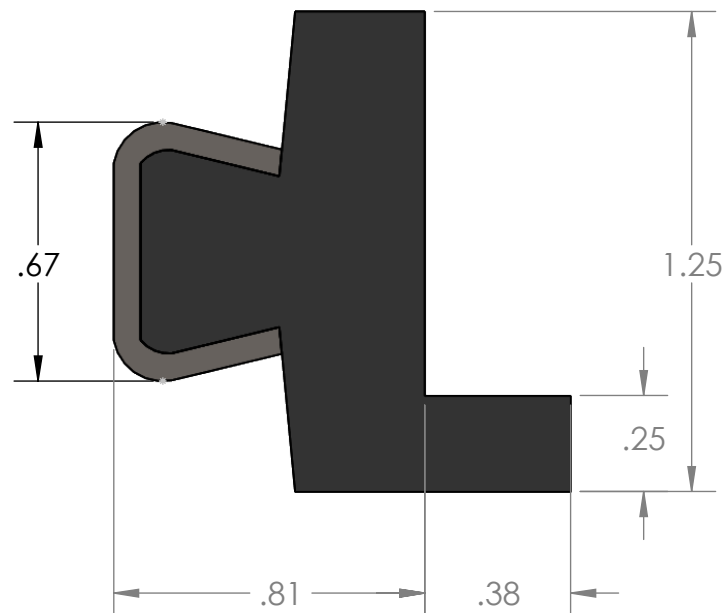

A

A

PROPRIETARY AND CONFIDENTIAL
THE INFORMATION CONTAINED IN THIS DRAWING IS THE SOLE PROPERTY OF MASON PLASTICS COMPANY. ANY REPRODUCTION IN PART OR AS A WHOLE WITHOUT THE WRITTEN PERMISSION OF MASON PLASTICS COMPANY IS PROHIBITED.

		UNLESS OTHERWISE SPECIFIED:		NAME	DATE	TITLE: .38" Lubricated Solid Edge Guide Rail		
		DIMENSIONS ARE IN INCHES TOLERANCES: ±0.01	DRAWN	Charles Kirk	10/10/18			
		INTERPRET GEOMETRIC TOLERANCING PER:	CHECKED					
		MATERIAL	ENG APPR.					
		Wax Filled UHMW-PE/ 304 Stainless Steel	MFG APPR.					
			Q.A.					
			COMMENTS:			SIZE A		
			Meets FDA21CFR 177.1520 Recommended for Food Industry Products					
NEXT ASSY	USED ON	FINISH 2B				DWG. NO. MPSSLTS1038MS12	REV	
APPLICATION		DO NOT SCALE DRAWING				SCALE: 1:8	WEIGHT:	SHEET 1 OF 1

2

1