

2

1

B

B

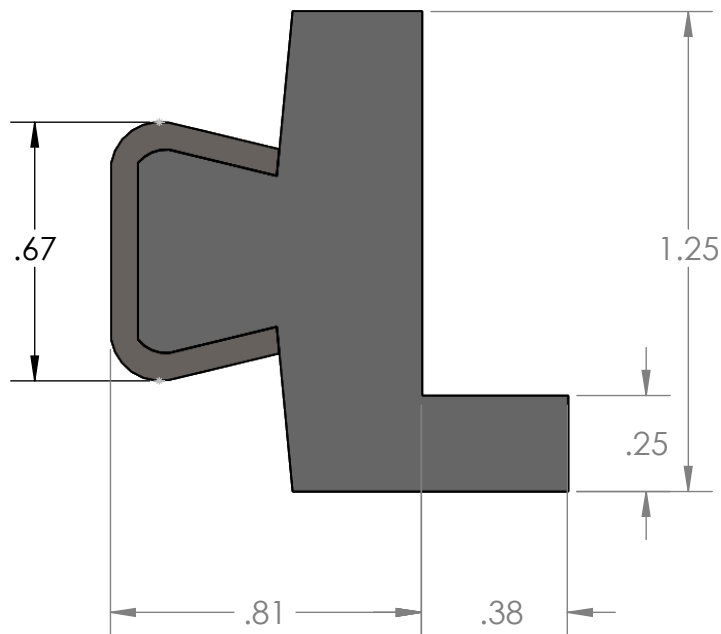

A

A

PROPRIETARY AND CONFIDENTIAL
THE INFORMATION CONTAINED IN THIS DRAWING IS THE SOLE PROPERTY OF MASON PLASTICS COMPANY. ANY REPRODUCTION IN PART OR AS A WHOLE WITHOUT THE WRITTEN PERMISSION OF MASON PLASTICS COMPANY IS PROHIBITED.

| | | | | | | | | |
|-------------|---------|---|-----------|--------------|----------|--|--|---------|
| | | UNLESS OTHERWISE SPECIFIED: | | NAME | DATE | TITLE: <div>.38" Solid Edge Guide</div> | | |
| | | DIMENSIONS ARE IN INCHES TOLERANCES: ±0.01 | DRAWN | Charles Kirk | 10/10/18 | | | |
| | | INTERPRET GEOMETRIC TOLERANCING PER: | CHECKED | | | | | |
| | | MATERIAL | ENG APPR. | | | | | |
| | | Natural UHMW-PE/ 304 Stainless Steel | MFG APPR. | | | | | |
| | | | Q.A. | | | SIZE <div>A</div> | | |
| | | | COMMENTS: | | | | | |
| | | | | | | | | |
| | | | | | | DWG. NO. MPSSLTS103820 | | REV |
| NEXT ASSY | USED ON | FINISH 2B | | | | SCALE: 1:8 | | WEIGHT: |
| APPLICATION | | DO NOT SCALE DRAWING | | | | SHEET 1 OF 1 | | |

2

1